

FORM NO. 1.

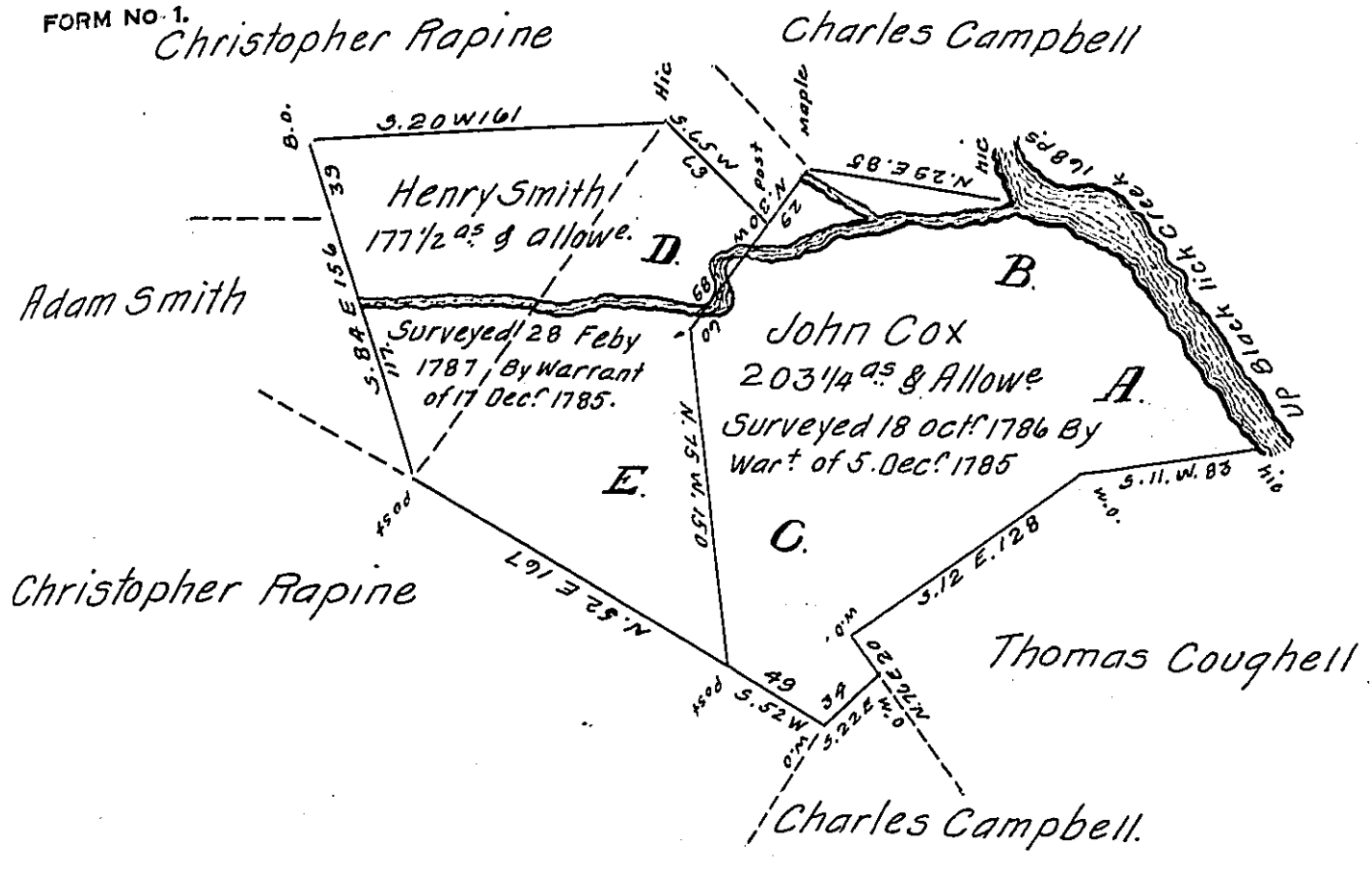

That part of the above diagram represented by the dotted line including the letters A. B. C. D. E. shows the Survey made to George Mc Connell on the 25 of January 1828. a return where of is here with enclosed. It will be seen by a reference to the dates in the above diagram that the land has been previously Surveyed on warrants issued by the Commonwealth at the times therein stated. The Survey now made for George Mc Connell is occupied by George Rapine who claims on the title of John Cox. which tract I am informed is patented. The tract in the name of Henry Smith is occupied by the Widow Moorhead but not owned by her, owned I understand by a person by the name of Smith in Westmoreland County. The Survey of Mc Connell I have made upon the land called for by the Location as near as can be ascertained. It has been laid upon the first run below the crossing of of the Kittaning path on ~~the tract~~ what I am informed was at an early day called the West Side of Black Lick Creek. but which is more properly the North or North West side. - There is no person claiming under this Location at present known to me.

To Gabriel Hiester Esq^r John Taylor D. S.
Surveyor General.

IN TESTIMONY that the above is a copy of the original remaining on file in the Department of Internal Affairs of Pennsylvania, made conformably to an Act of Assembly approved the 16th day of February, 1833, I have hereunto set my Hand and caused the Seal of said Department to be affixed at Harrisburg, this twenty first day of September 1908.

Henry Howell
Secretary of Internal Affairs.